

KUBOTEK®



CAD File Discrepancy Report Software

What's New in 3.0

Table of Contents

Enhanced Assembly Compare

PAGE

3

Report Enhancements

4-6

New STEP AP242 Reader Support

7

New Compressed STEP Reader Support

7

Interface

9-12

Updated Read Formats

13

Enhanced Assembly Compare

Assembly compare has been enhanced to graphically view assembly differences with 3 different viewing modes

- Easily view assembly BOM, identifying name changes, part references added or removed from assemblies, and positional differences within the assembly.
- Quickly view Part geometry differences individually.
- Reports can be created for any mode of assembly compare

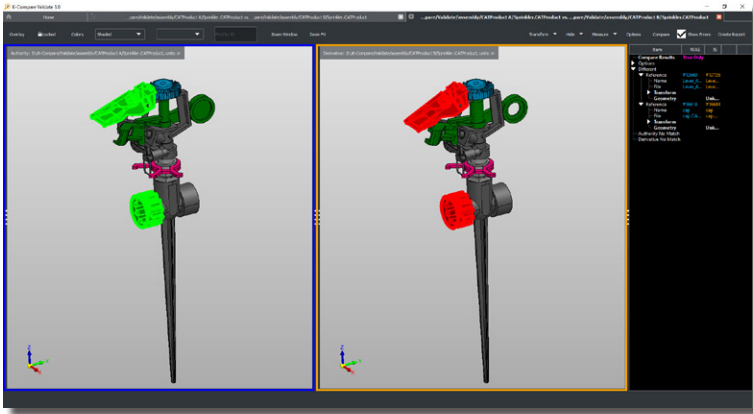

Part reference differences viewing

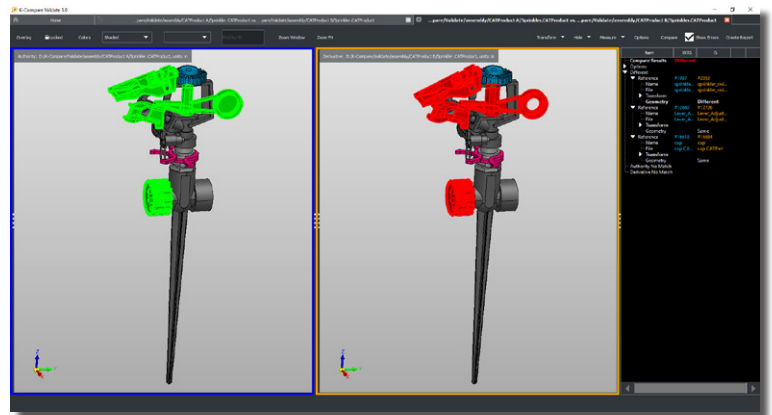

Part references with geometry compare viewing

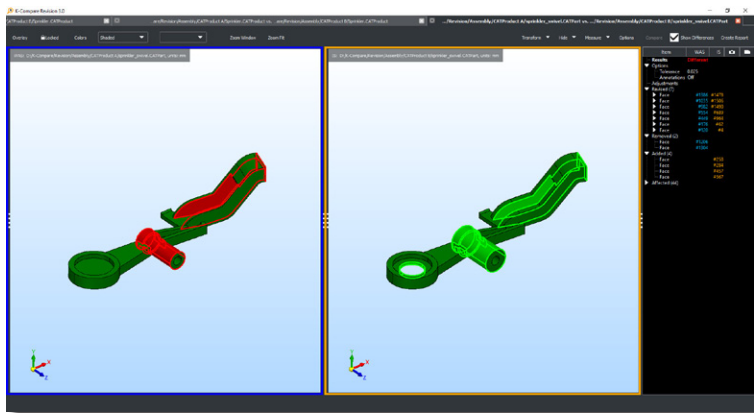

Individual part compare

Report Enhancements

Report capabilities have been enhanced to give users not only more functionality but greater flexibility in creating and modifying reports

New Locator View

- A locator view is a smaller overall view of the model with an area highlighting where the difference is on the model
- This makes it extremely easy to find where the difference is on the model that you are showing

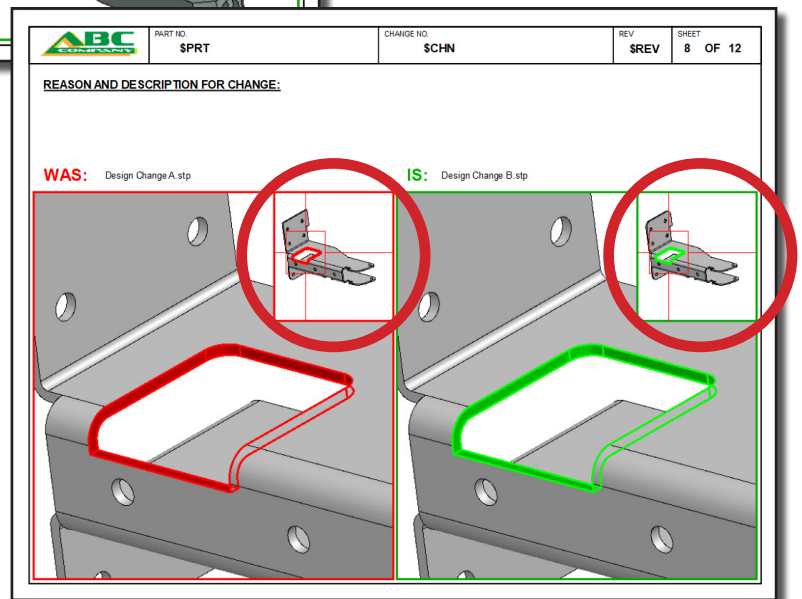
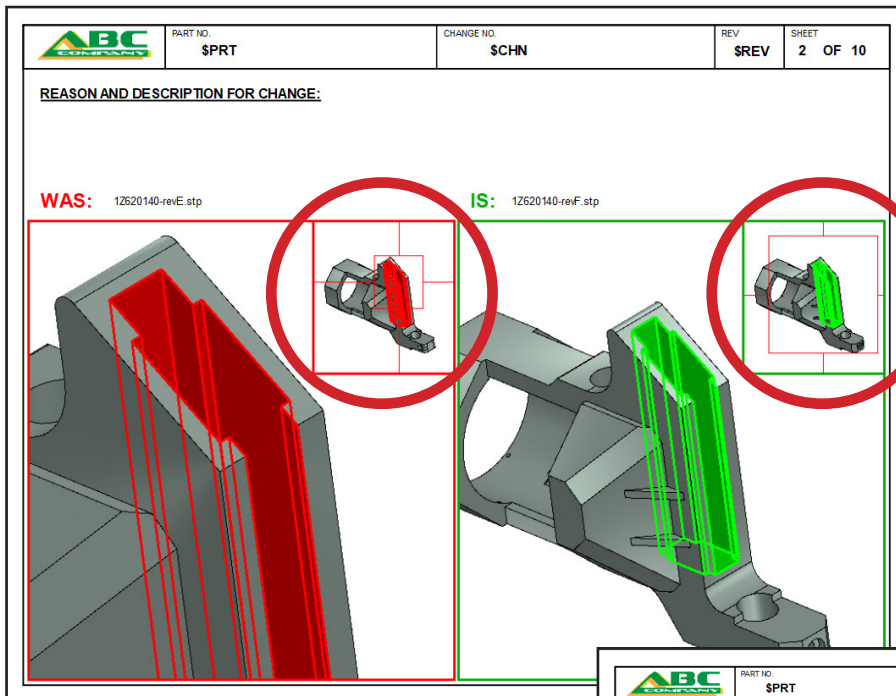

Measurement tools

- New measurement tools have been added to quickly add measurements to a report
- Measurements allow users to explain the changes more effectively
- 4 measurement tools are available
 1. Radial Measurement
 2. Diameter Measurement
 3. Linear Measurement
 4. Coordinate Measurement

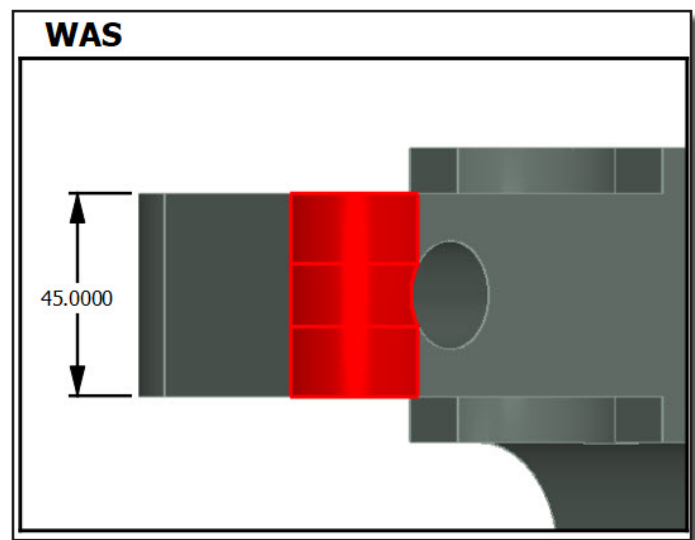
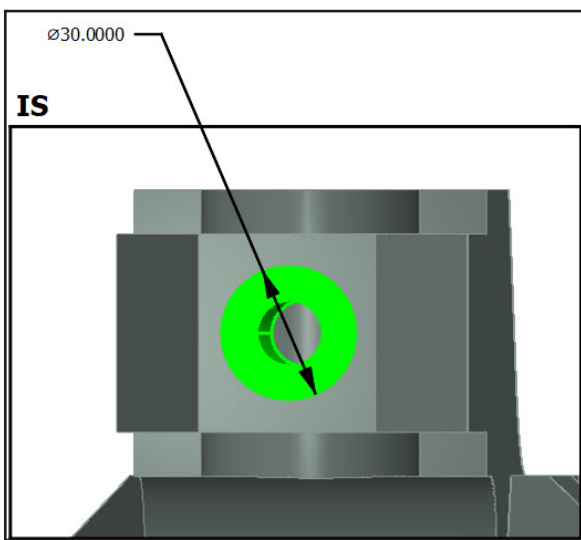
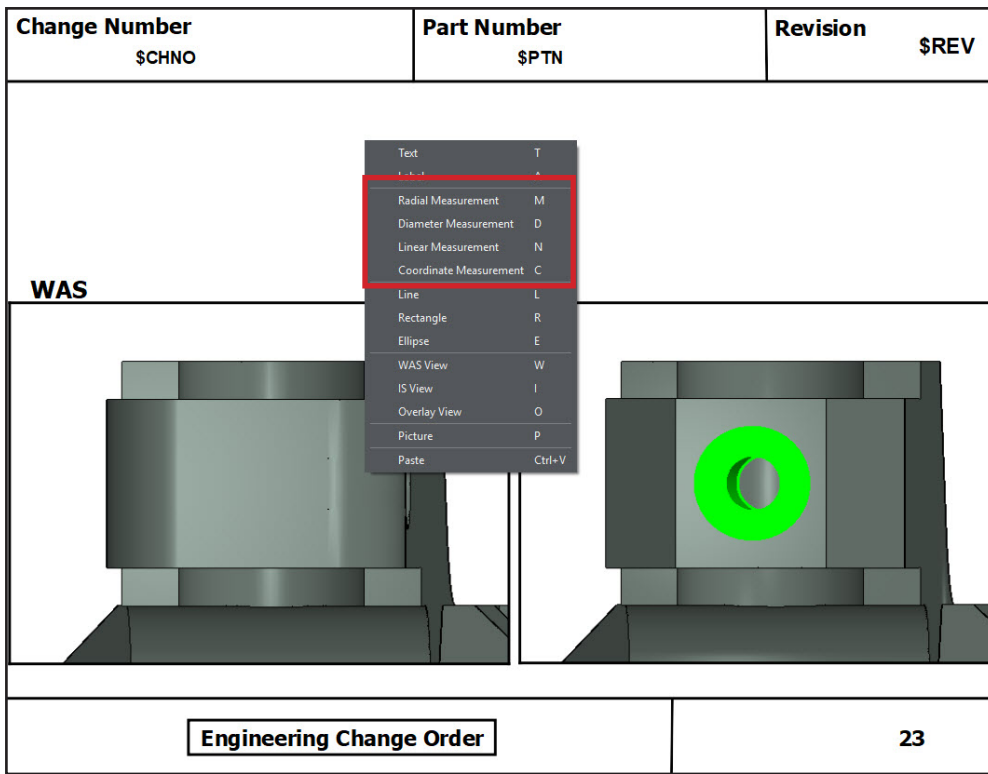

Label Enhancement

- Labels can now have multiple leaders
- Users can point to 1 or multiple areas in the report page from 1 label

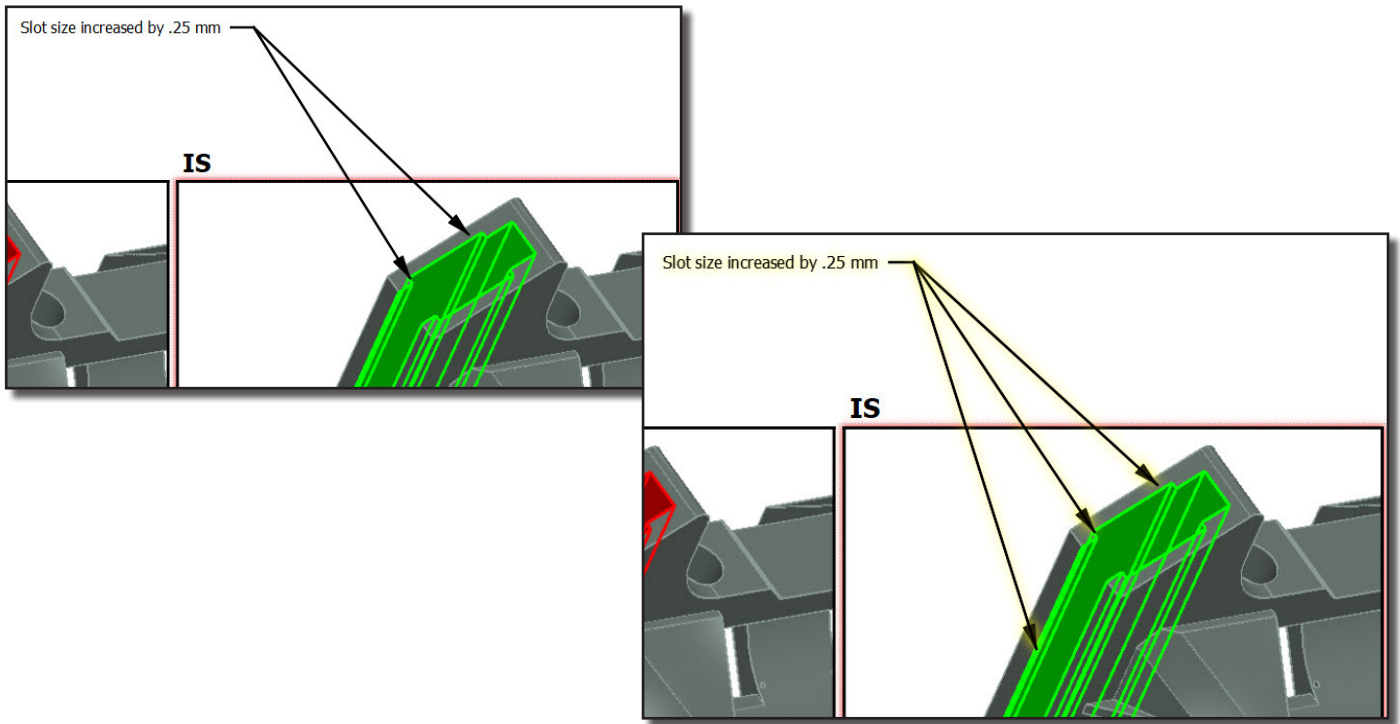

Report Element Highlighting

- Easy to see when selecting 1 or multiple elements on the report

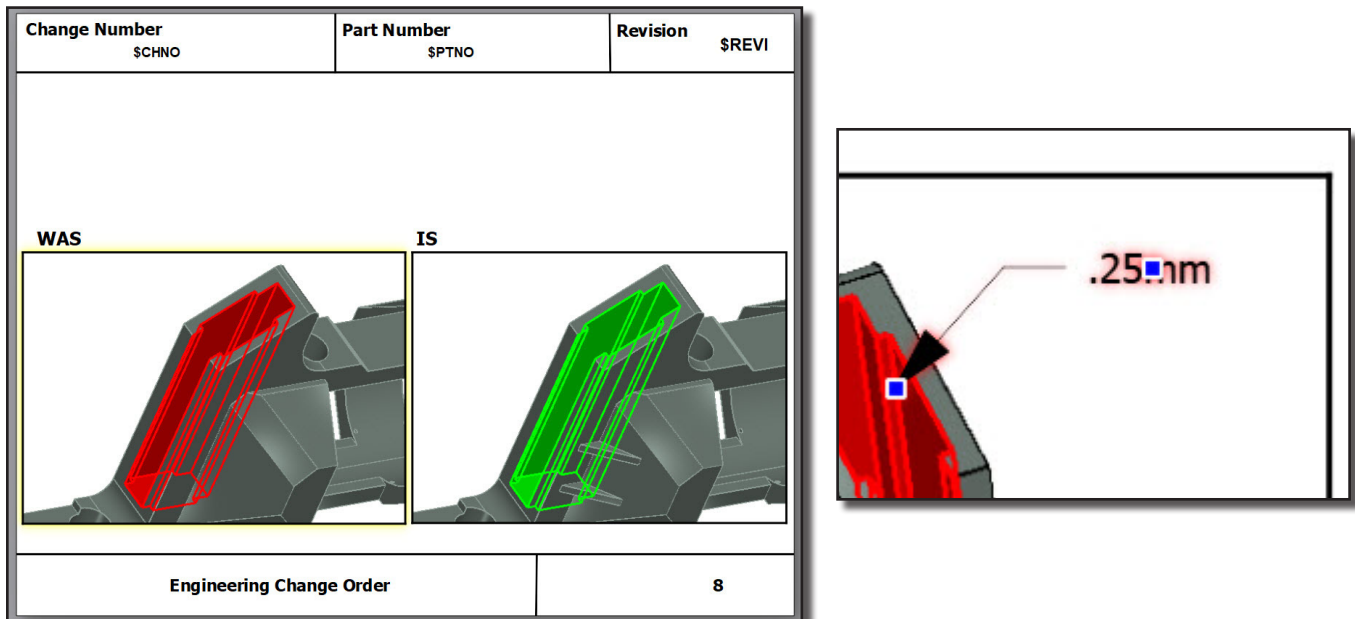

Element Lock and Unlock

- Allows users to unlock elements in the report template to create a custom report
- Elements (views, text, measurements, etc.) can be locked to prevent unwanted editing

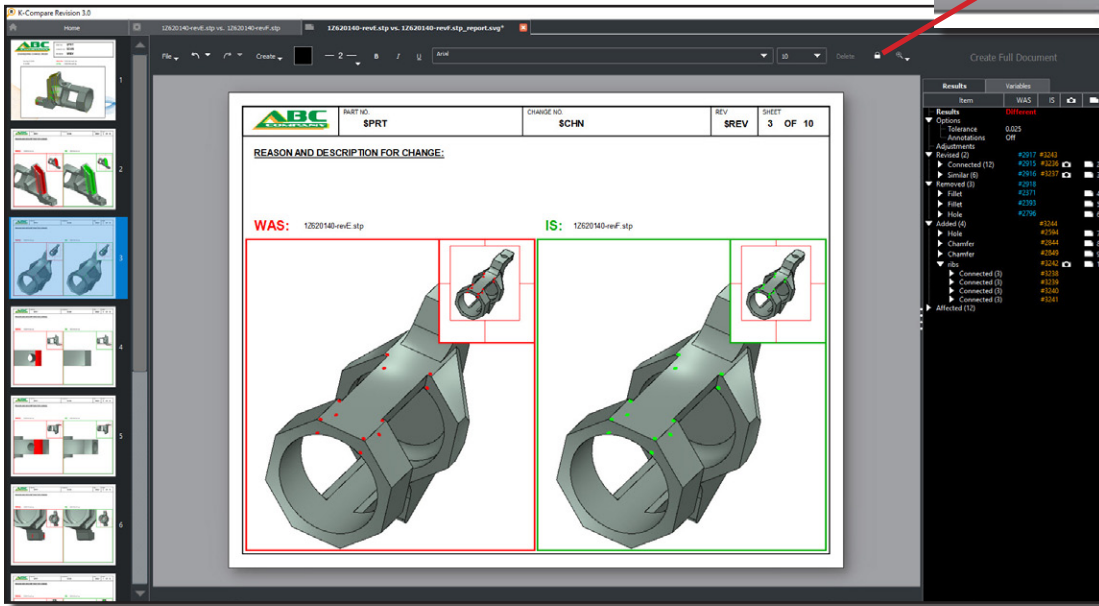
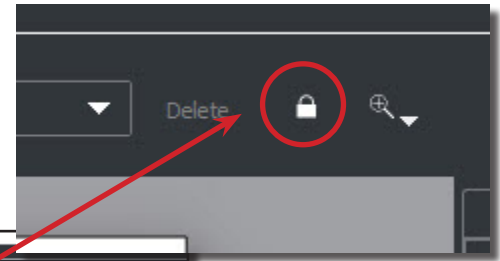

General Enhancements

- A revised sample/default report template has been added
- Keyboard keys Page Up and Page Down always change the active page in the report to the next lower or higher page.
- Keyboard Home key goes to the first page of the report
- Keyboard End key goes to the last page of the report
- An image can now be used for a background

New STEP AP242 Reader Support

The STEP AP242 standard focuses on product data representation to support CAD/CAE and PDM data exchange, system integration, visualization, and long-term preservation of product information.

- Model Based Development (MBD)
- PDM integration and PDM services
- Long Term Archiving (LTA)
- Supply chain integration
- Engineering design data
- Advanced Product Manufacturing Information (PMI)

Ability to read:

- Assemblies
- B-Rep models
- Graphical PMI

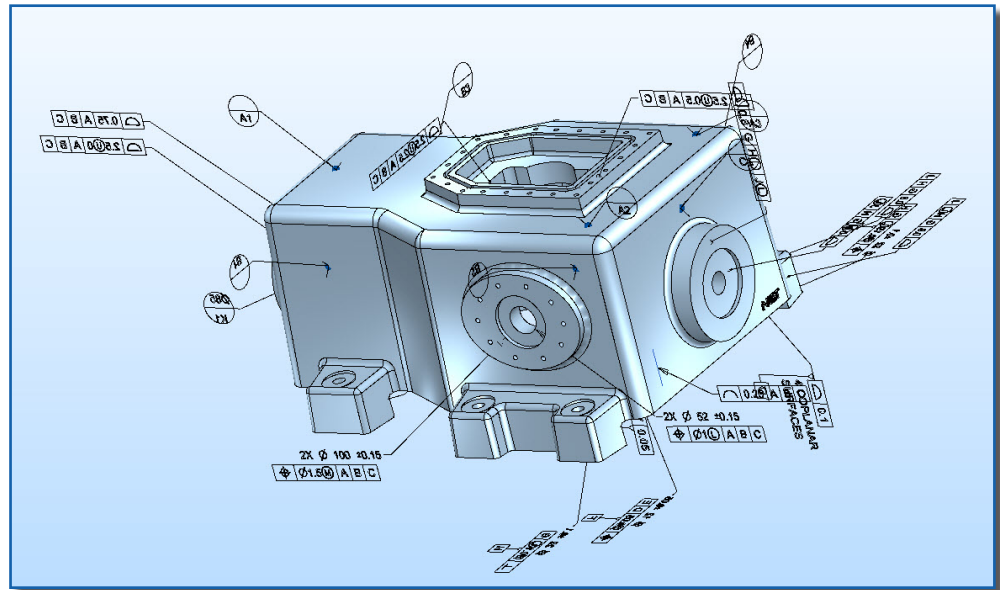

STEP AP242 example file

New Compressed STEP Reader Support

- STEP reader has been enhanced with the Compressed file type

```
DWG/DXF (*.dwg *.dxf)  
IGES (*.iges *.igs)  
STEP (*.stp *.step *.stpZ)  
ACIS (*.sat *.sab)  
Parasolid (*.x t *.x b)
```

Interface

K-Compare Revision interface has been enhanced for a better user experience.

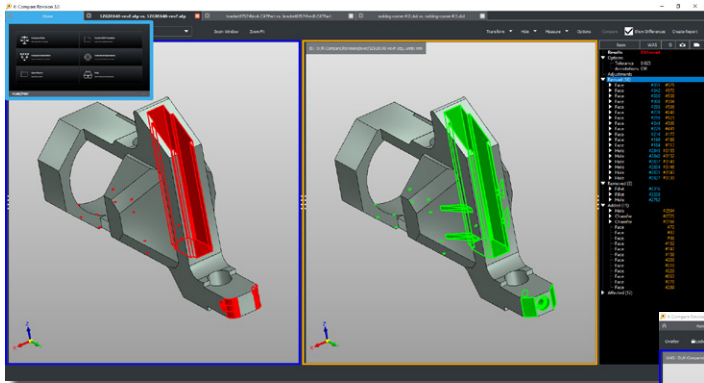

New tab preview shows you the contents of that tab before selecting the tab

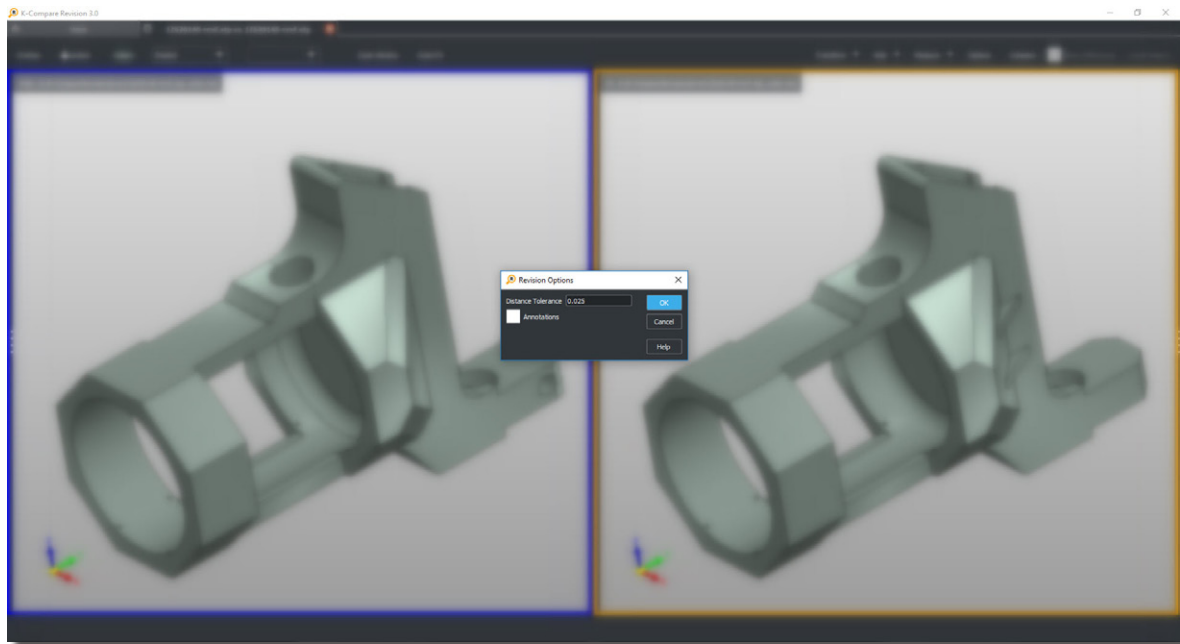
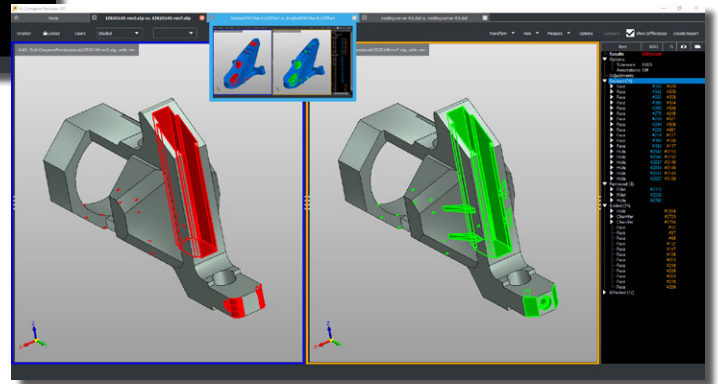

When a dialog window is opened the interface gets blurred out except for the opened dialog window.

General visual improvements to graphics & display

- Changed the light sources and ambient camera light so that bright and dark areas in the display area show strong highlights and shadows. This makes the
- X, Y, Z Labels have been added to the Axis indicator for greater ease of use
- Black edges on models for a cleaner look
- Zoom Fit margin leaves less empty space around the edges of the viewport display
- Improved visual difference of hidden status in the part tree

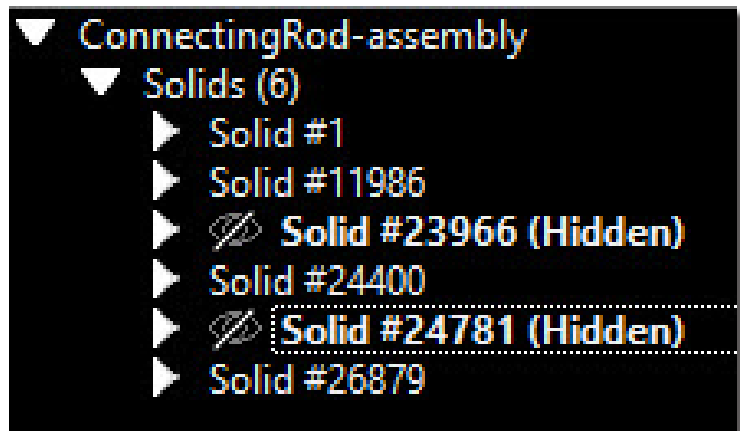
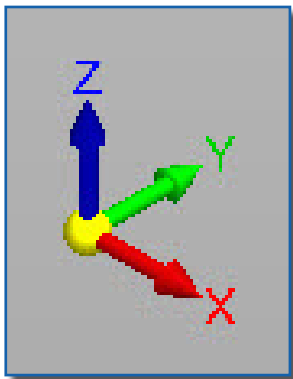
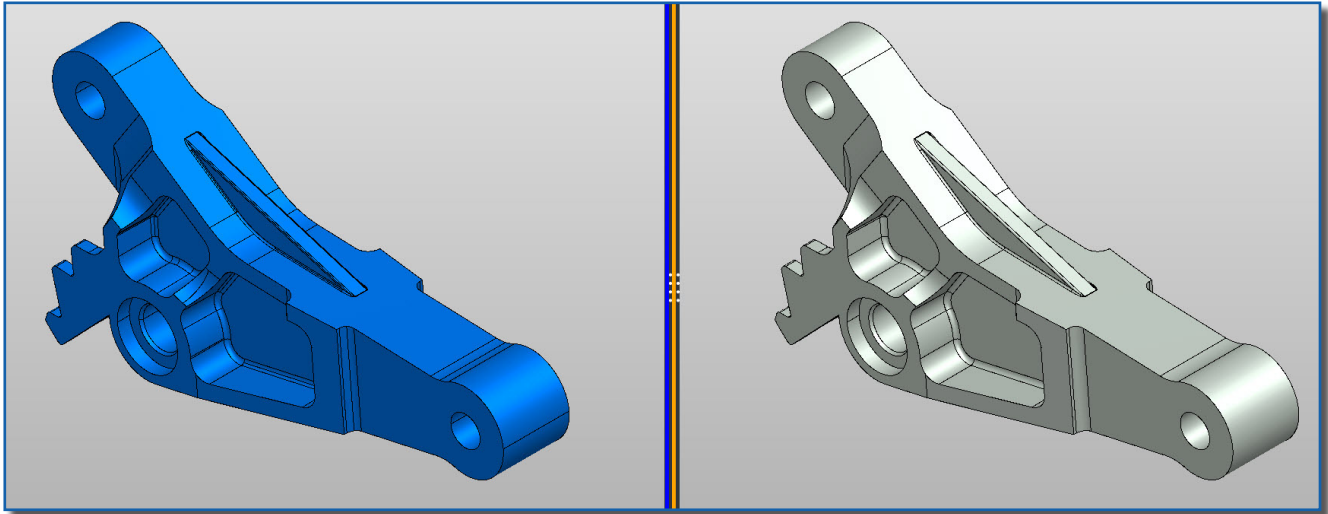

Compare Result Tree grouping and sorting has been enhanced. This allows the user to easily and quickly group and sort differences for the reporting process

Grouping options:

- **Group Connected Faces** – Groups connected faces into their own sub-folder(s)
- **Group Similar Features** – Groups similar features into their own sub-folder(s)
- **Group Coaxial Holes** – Groups coaxial holes into their own sub-folder(s)

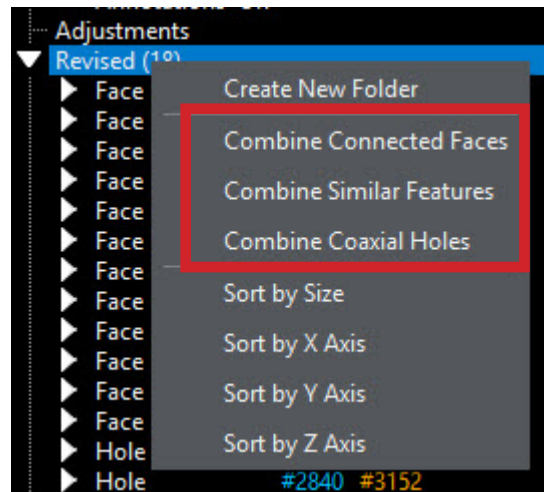

Sorting options:

- **Sort by Size** – Sort a feature or all the faces of a group and sort them in a descending order
- **Sort by X Axis** – Sort a feature or group and puts it in ascending order based on the minimum point of the box along the X axis
- **Sort by Y Axis** – Sort a feature or group and puts it in ascending order based on the minimum point of the box along the Y axis
- **Sort by Z Axis** – Sort a feature or group and puts it in ascending order based on the minimum point of the box along the Z axis

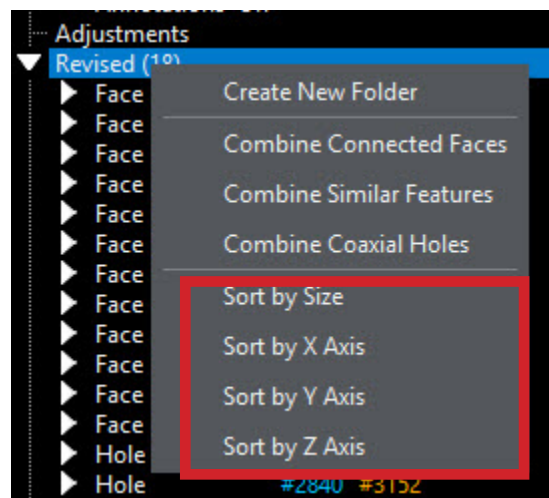

Finish/Cancel Icons

- Finish/Cancel selectable buttons are presented for functions from Main menu that allow multiple entity selections.

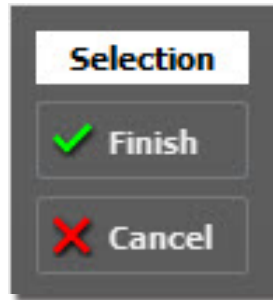

Improved Tooltip Information

- Tooltips include feature holes, fillets, chamfer and face information where applicable. Consistent diameter vs. radius measurements are based on entity type.

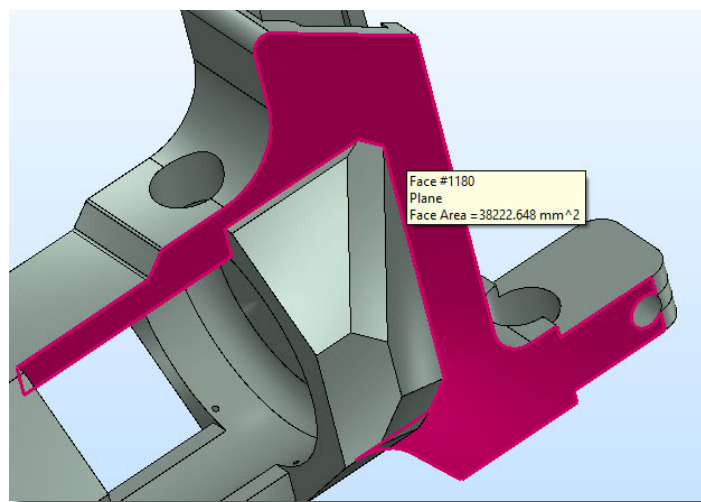
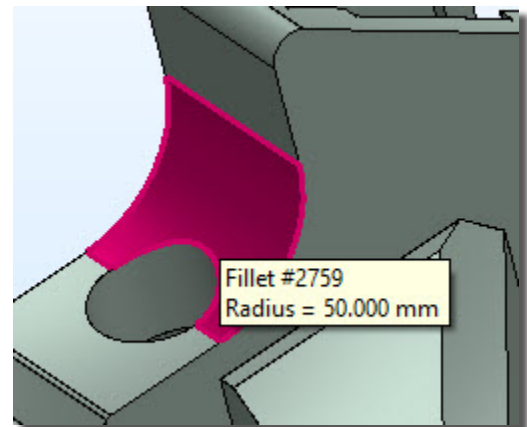
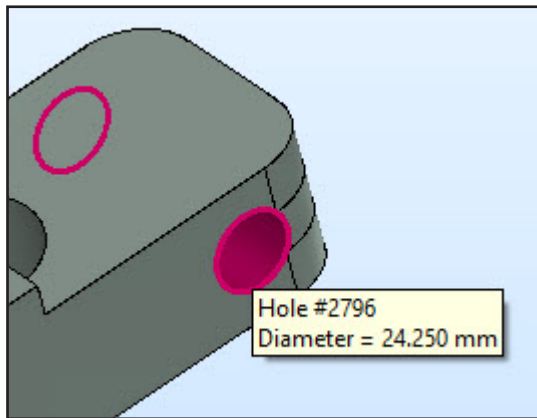

Updated Read Formats

K-Compare Revision continues improvements on its extensive format read capabilities with several format updates.

Dassault CATIA V6/3DEXperience

- 3D read extended to R2020x

PTC Creo, (Pro/E)

- 3D read extended to V7.0

Autodesk Inventor

- 3D read extended to 2021

Siemens NX

- 3D read 1911, 1915, and 1919



Kubotek3D

2 Mount Royal Ave. Suite 500, Marlborough, MA 01752

Phone: 800-372-3872

www.kubotek3d.com

sales@kubotek3d.com